

## Addendum to Request for Proposals for Cleaning Services - 2019

October 29, 2019

1. Is the parking garage included in the RFP? It was not specifically called out in the scope of work. If so, what are the specific tasks? Frequencies?

Yes, the parking garage vestibule is included in the scope of work. This includes approximately 300 square feet of carpeting, windows, and 2 exterior and 1 interior trash / recycling receptacles.

Frequencies: As stated in RFP for carpeting, interior windows, trash / recycling receptacles, etc.

2. Does OPPL have a floor plan detailing square footage, floor type, restrooms, restroom fixtures?

See below for maps with flooring type for the Main Branch Library which has approximately 3800 square feet of carpeting. Note the flooring maps are not precise. These are for general location and size only.

We do not have maps of the Dole Branch Library, and Maze Branch Library floor plans are included below. Approximately half of the square footage noted on page 3 of the RFP is carpeted at Dole and Maze branches. Approximately half of the flooring at these locations is vinyl (or similar) commercial tile.

2 restrooms at the Maze Branch Library.

17 restrooms at the Main Branch Library

11 single use.

3 Women restrooms each with 3 toilets, 3 sinks.

3 Men restrooms each with toilet, urinal, 2 sinks.

All include: Porcelain fixtures, chromed faucets / handles, tiled walls, stainless steel partitions.

Restrooms at Dole Branch Library are sourced through the Park District and excluded from the scope of work.

3. Does "Clean all interior glass/metal" under the quarterly cleaning schedule exclude the perimeter (outside facing) windows? It usually does, but just confirming.

No. The perimeter (outside facing windows) should be spot cleaned daily, only on the inside.

Interior windows (perimeter included) should be fully cleaned quarterly.

The Firms proposal should clearly designate additional charges for cleaning perimeter (outside facing) windows if these charges are not included in the total cost quoted.

**MAIN LIBRARY  
FIRST FLOOR**



212'

152'

**MAIN  
ENTRANCE**

<p><b>CARPET</b></p>	<p><b>ECO SURFACE</b></p>	<p><b>TERRAZZO / TILE</b></p>	<p><b>PAINTED CONCRETE</b></p>
----------------------	---------------------------	-------------------------------	--------------------------------

**MAIN LIBRARY  
SECOND FLOOR**



**CARPET**

**ECO SURFACE**

**TERRAZZO / TILE**

**PAINTED CONCRETE**

**MAIN LIBRARY  
THIRD FLOOR**



212'

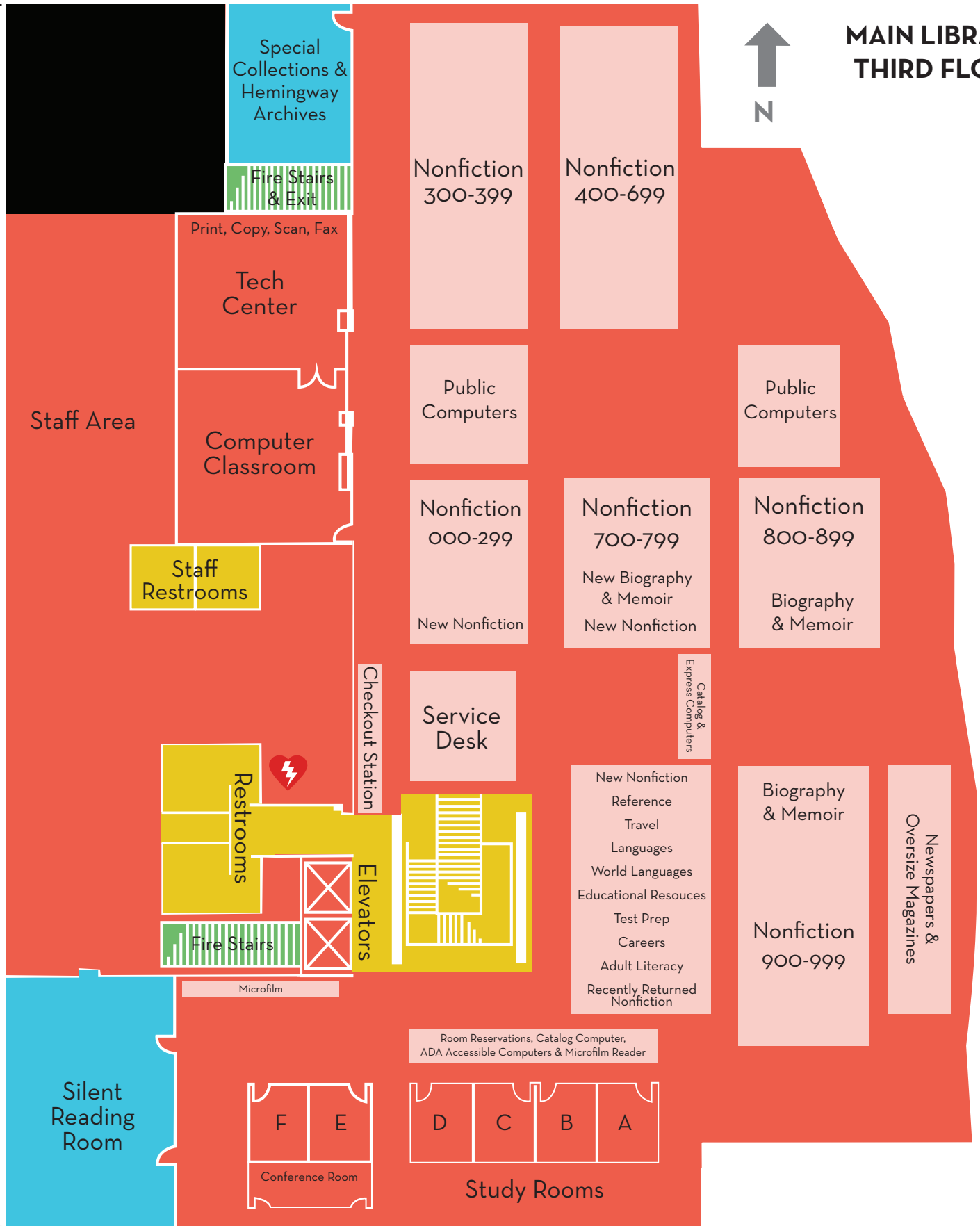

167'

**CARPET**

**ECO SURFACE**

**TERRAZZO / TILE**

**PAINTED CONCRETE**

MAZE  
BRANCH  
UPPER  
LEVEL

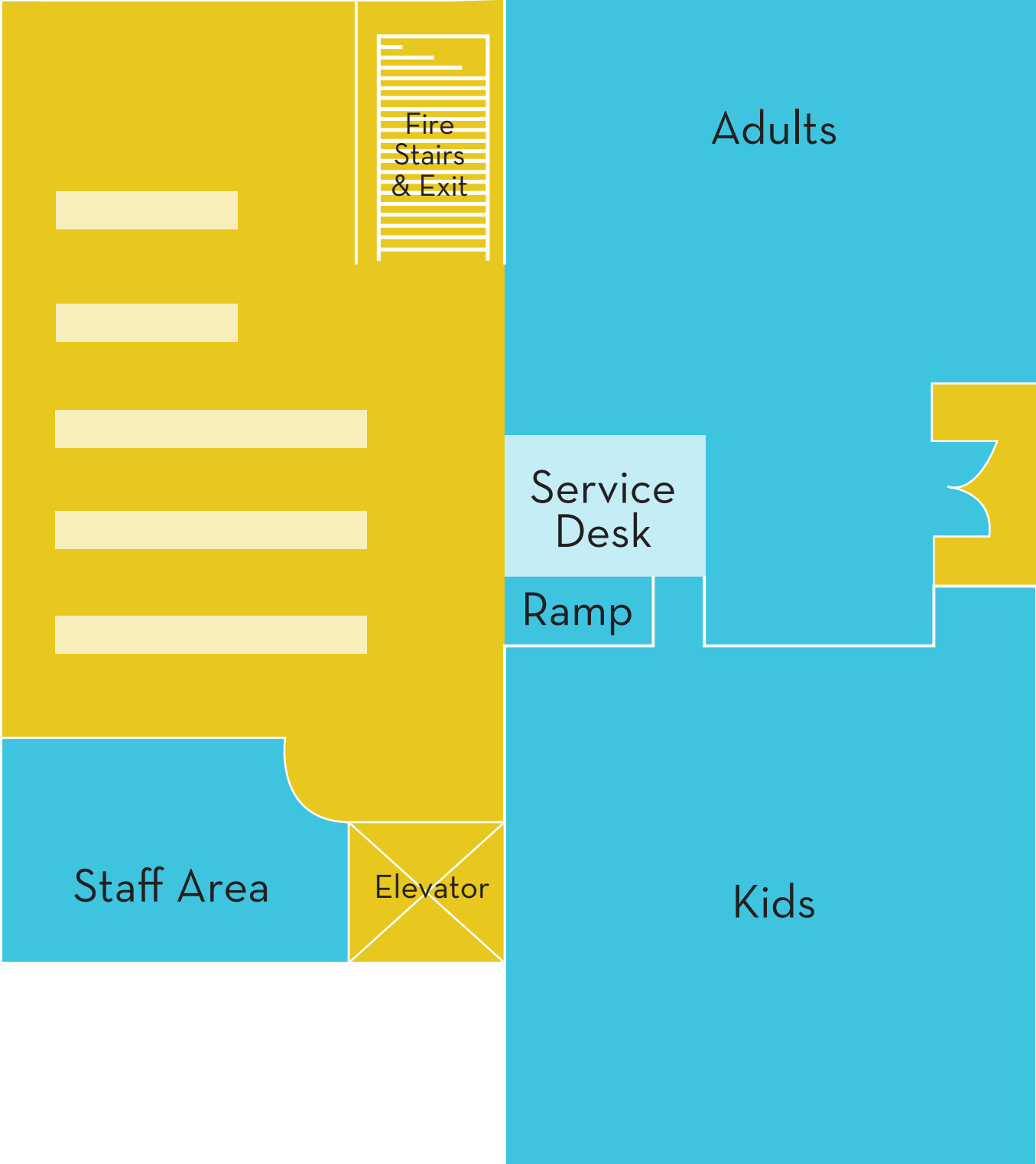

MAIN  
ENTRANCE

CARPET

TERRAZZO / TILE

MAZE  
BRANCH  
LOWER  
LEVEL

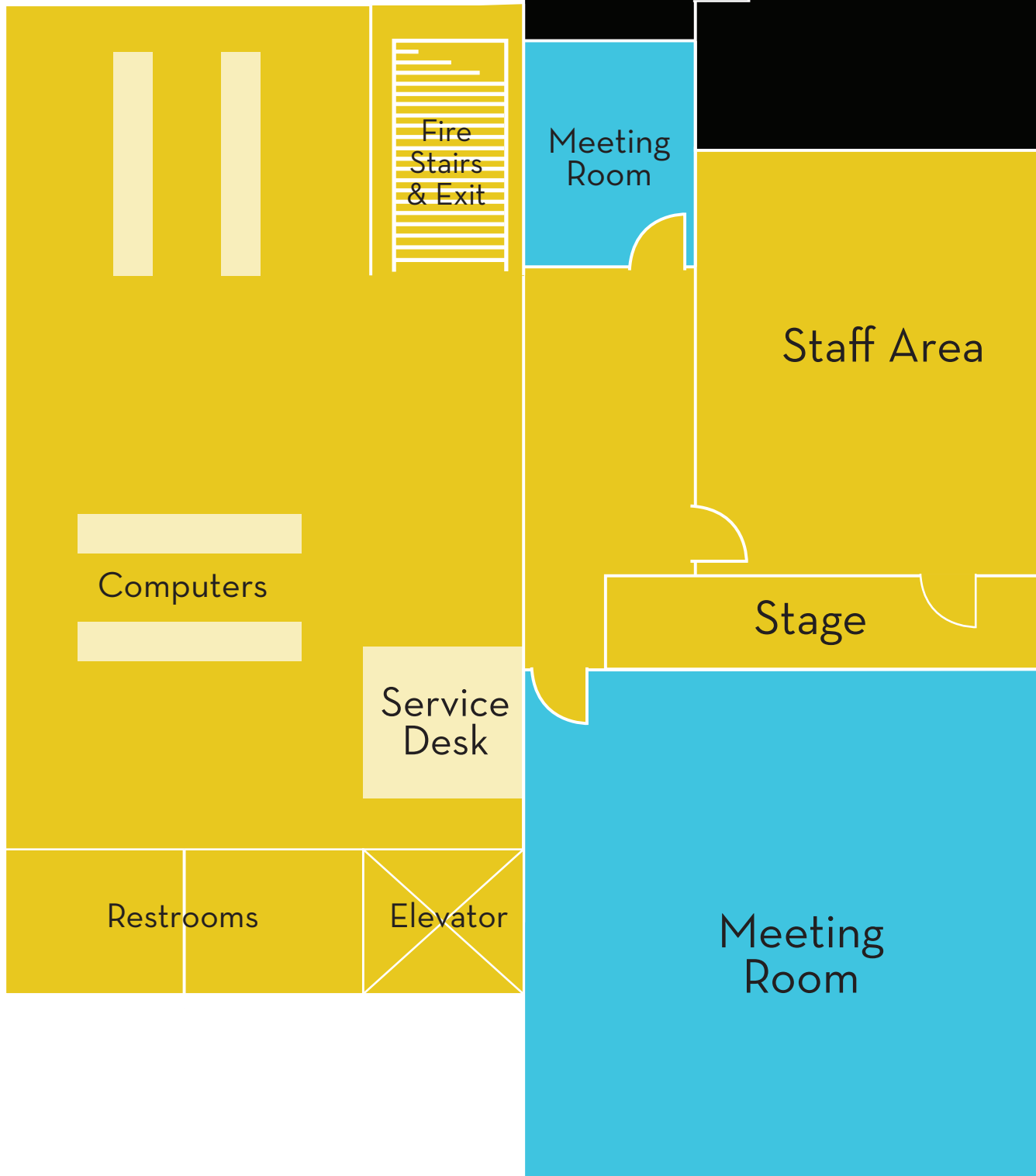

CARPET

TERRAZZO / TILE